

## Contents

Assembling the Method Sixty Litre Bin .....	1
Assembling the Method Twenty Litre Bin .....	2
Lining a Method Sixty or Twenty Litre Bin .....	2
Method Sixty Litre Bin Troubleshooting .....	3
Attaching a Method Flex Connector .....	3
Attaching an Expansion Kit .....	6
Assembling a Method Waste Precycler .....	8
Assembling a Method Paper Precycler .....	8
Cleaning and Bin Care .....	9
Applying Vinyl Labels .....	10
Applying Method Stream Labels .....	11

## Assembling the Method Sixty Litre Bin

Video instructions available at [methodrecycling.com/resources/how-to-assemble-your-method-bin](https://methodrecycling.com/resources/how-to-assemble-your-method-bin)

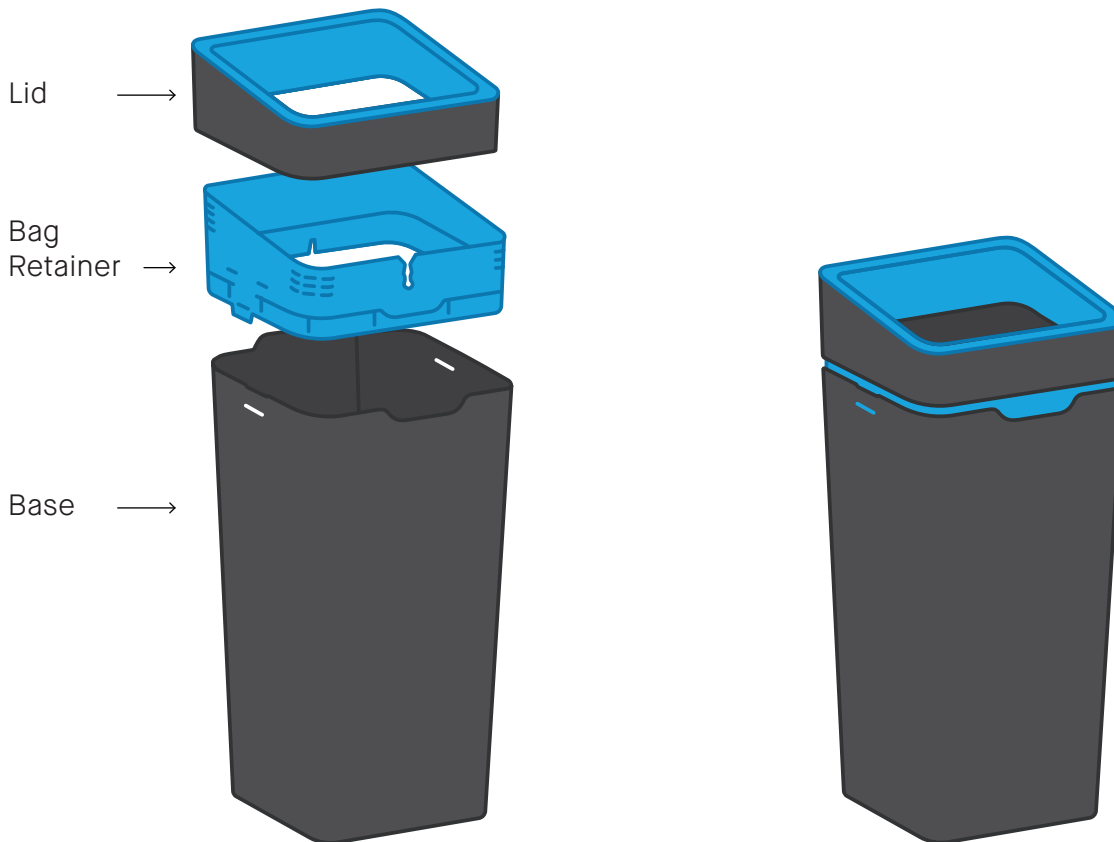

1. Gently pull the lid off the bag retainer.
2. Place the bag retainer into the base and make sure it clicks into the tabs on the sides of the bin base.
3. Place the lid on and you're ready to go.
4. Check out the bin placement guide on our website to maximise your results.

## Assembling the Method Twenty Litre Bin

Equipment needed: Phillips head screwdriver

Video instructions available at [methodrecycling.com/resources/how-to-assemble-a-20l-method-bin](https://methodrecycling.com/resources/how-to-assemble-a-20l-method-bin)

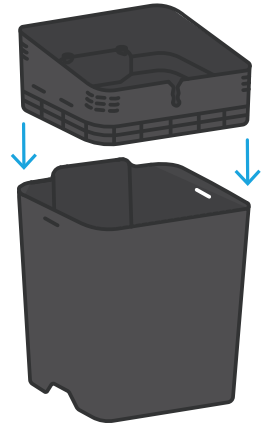

1. Place the bag retainer into the base.

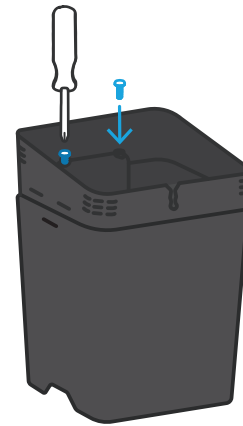

2. Screw the bag retainer into the back of the base using screws provided.

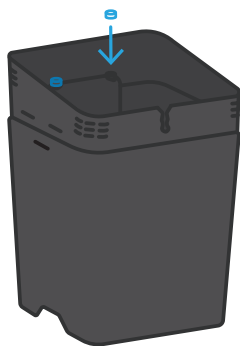

3. Place the screw covers provided over the screw heads.



4. Place the lid on and you're ready to go.

## Lining a Method Sixty or Twenty Litre Bin

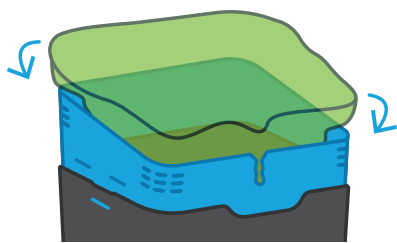

1. Remove lid and place liner in bin, pushing to the bottom. Wrap liner around bag retainer edge.

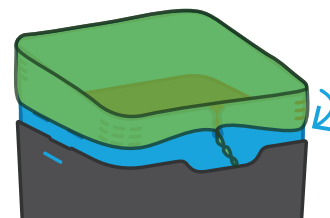

2. Pull excess liner to the front of the bag retainer. Bunch and twist excess liner together.

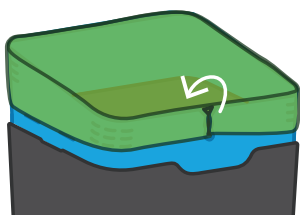

3. Tuck excess liner through slot and back into main cavity of the bin.

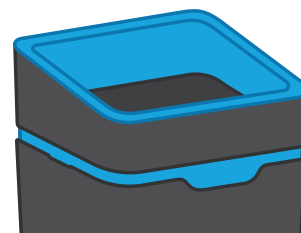

4. Place the lid on. The liner will stay in place for easy servicing.

## Method Sixty Litre Bin Troubleshooting

Side view:

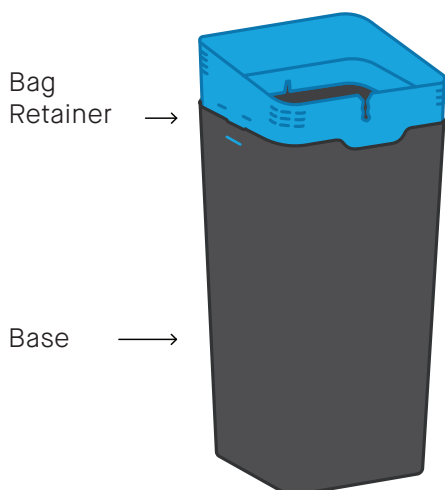

Top view:

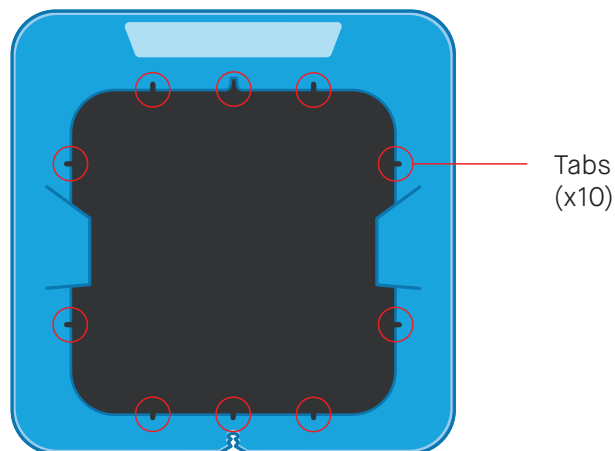

1. The Method Sixty Litre Bin is made of three parts: the lid, the bag retainer and the base. For this, you'll just need the bag retainer and the base (see the side view above).
2. The base has ten inner tabs that lock into the coloured bag retainer (see the top view above). Sometimes these can sit on the outside of the bag retainer, pushing the sides of the base out.
3. With the lid removed, please ensure the ten tabs are all visible inside of the retainer. If incorrectly installed it may make the base look warped or mis-shaped.
4. If you require assistance please contact [sales@methodrecycling.com](mailto:sales@methodrecycling.com). Make sure to supply photos showing the top and side of the assembled bin.

## Attaching a Method Flex Connector

Equipment needed: 4mm & 6mm hex keys

Video instructions available at [vimeo.com/841031889](https://vimeo.com/841031889)

### The anatomy of a Method Flex Connector

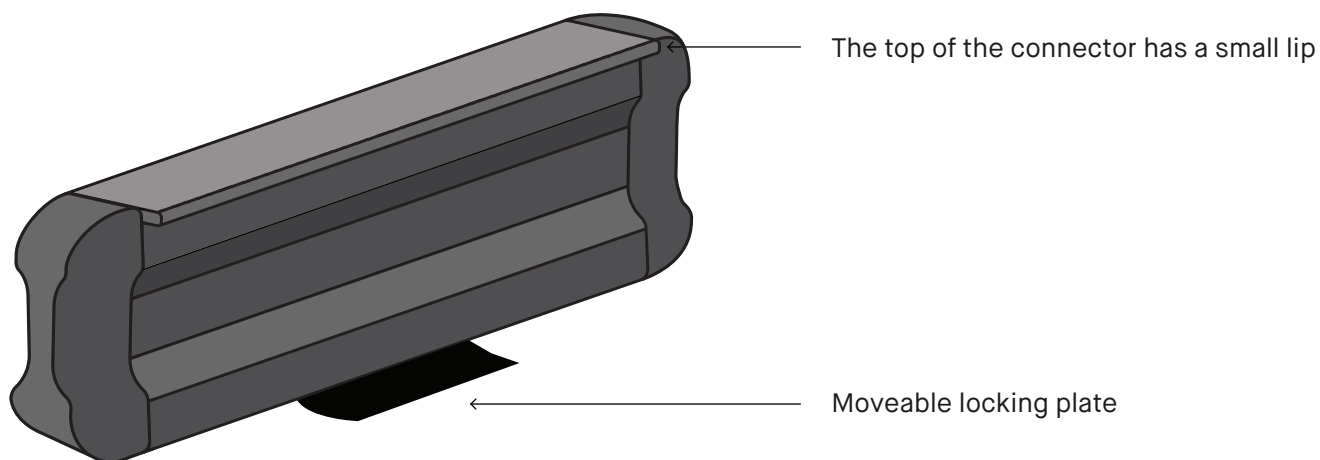

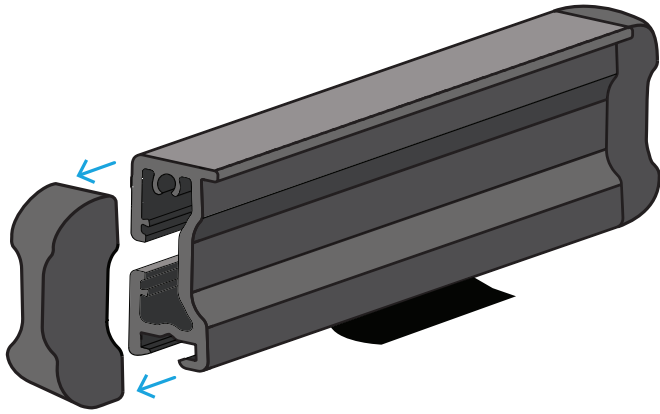

1. Take the connector and remove one end cap (it does not matter which end it is removed from).

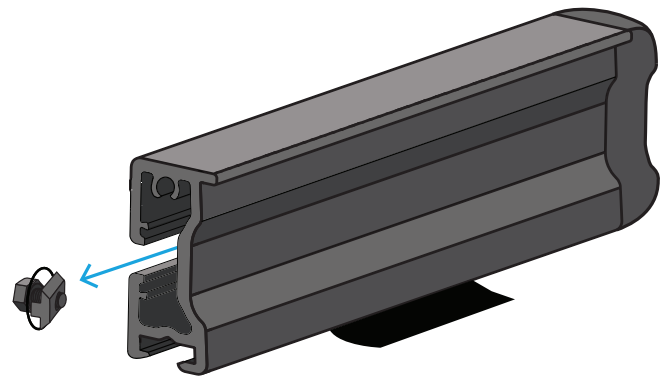

2. Loosen the two bolts slightly and slide out both bolt, washer and nut assemblies from the connector.

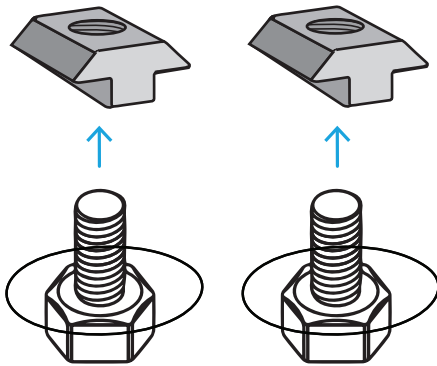

3. Remove the nuts from the assemblies, keeping the washer in place on the bolt.

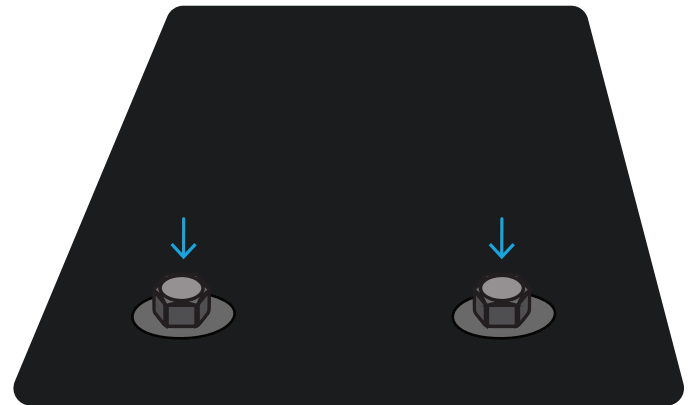

4. Insert the two bolts (with their washers still in place) through the holes in the back of the sign (the blank side).

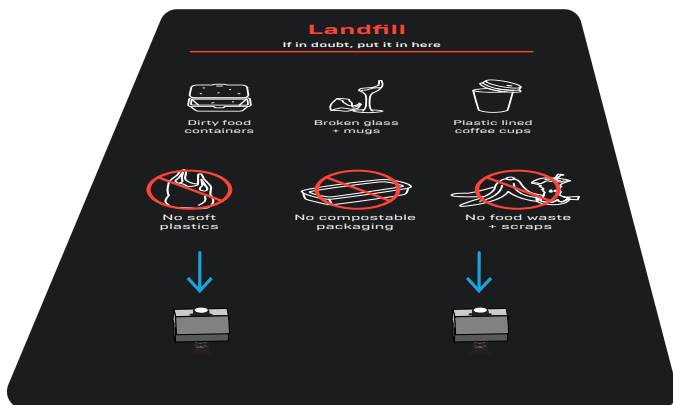

5. Flip the sign over. Loosely reattach the nuts to the bolts (only two rotations of the nut is necessary).

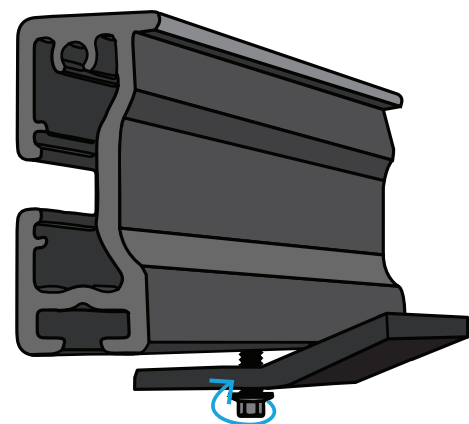

6. Take the connector and loosen the locking plate slightly (do not remove).

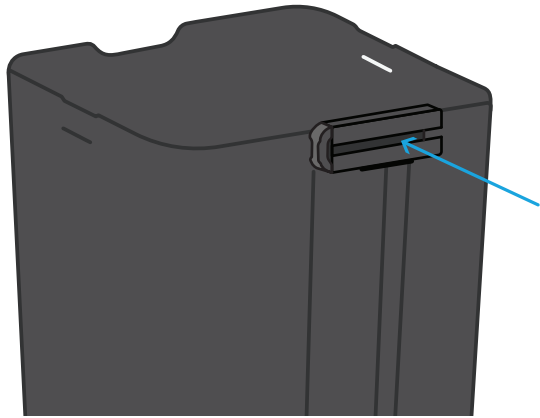

Side view:



7. Place the locking plate into the indent at the back of the bin. The connector's top lip should be at the top of the base.

8. Use a 5mm hex key to tighten the locking plate's bolt and ensure the lip of the connector is flush to the edge of the bin.

Back view:

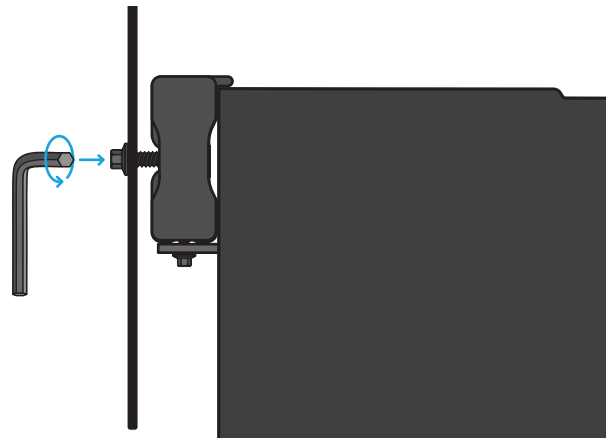
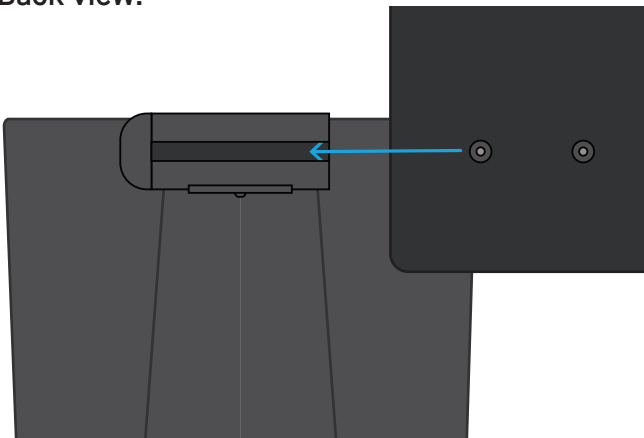

9. Ensure that one side of the connector still lacks an end cap. Attach the signage to the connector by sliding the two nuts protruding from the signage's front into the connector through the end with no cap.

10. Re-insert the second end cap to close the connector. After ensuring that the signage is centered on the bin, use a 6mm allen key to tighten the two bolts.



11. Insert the bin retainer, a liner and the lid (for further help with this, see pages 1 - 2).

## Attaching an Expansion Kit

If you have a station of four or more bins you will need to connect these with an Expansion Kit.

Video instructions available at [vimeo.com/269960323](https://vimeo.com/269960323)

### The anatomy of a Method Expansion Kit

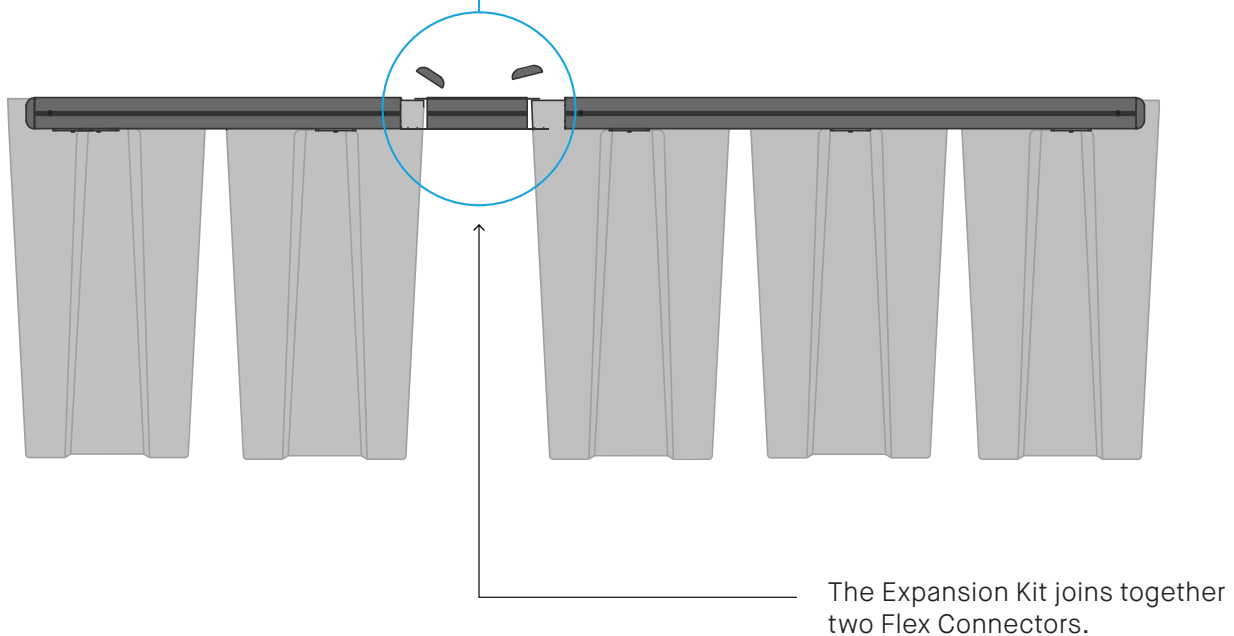
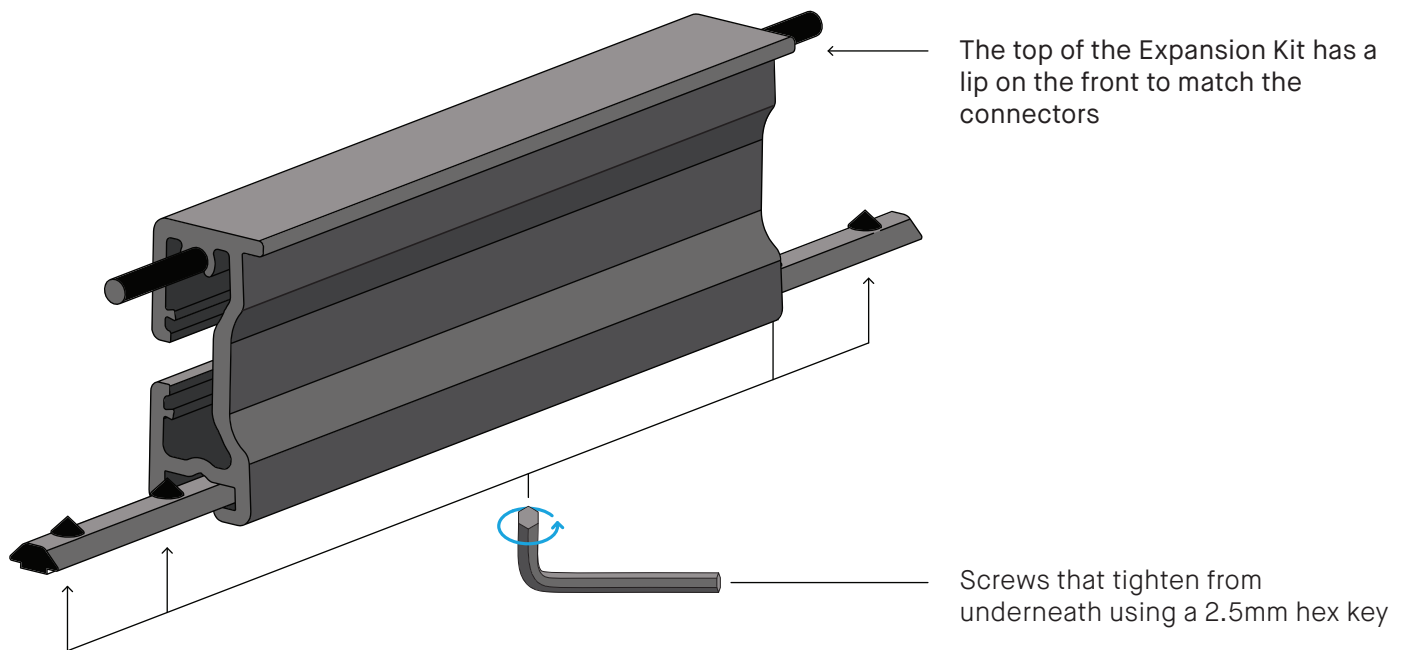

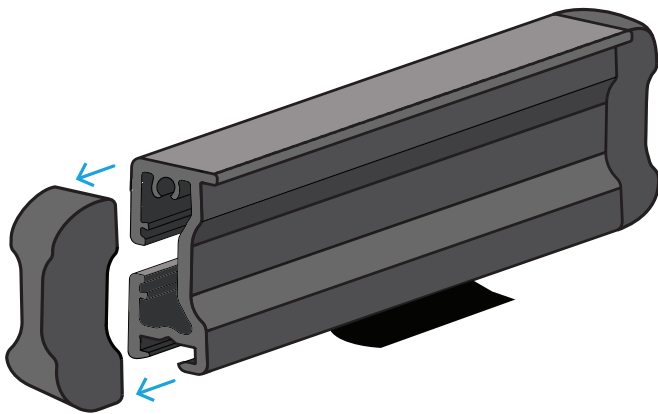
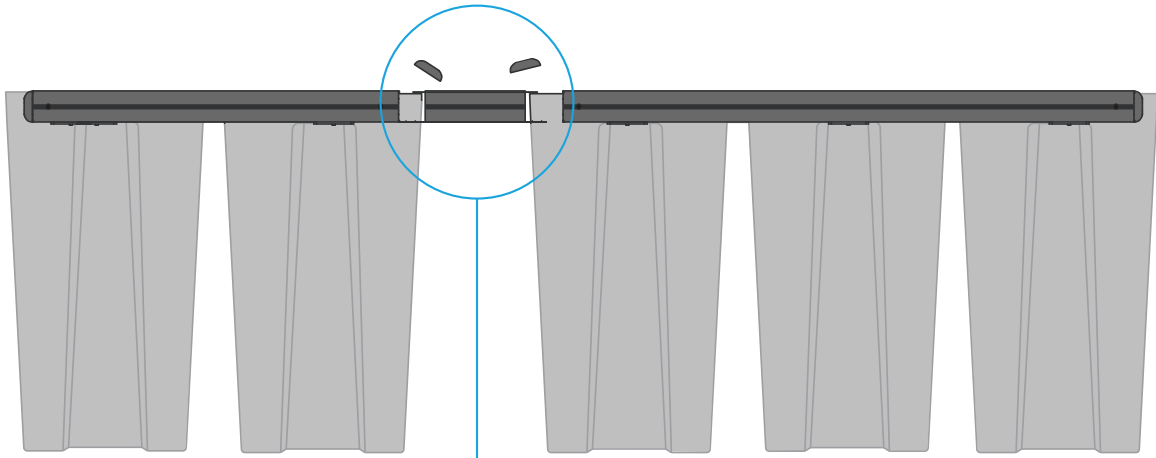

1. Remove the plastic end caps from the connectors.

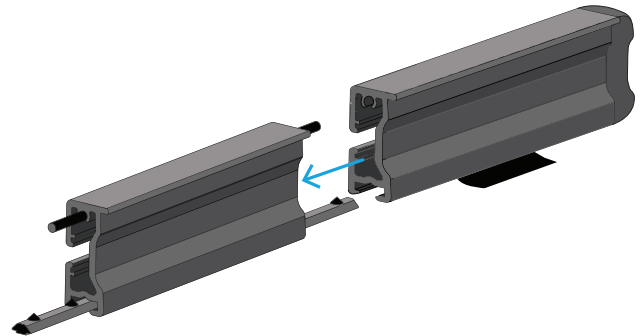

2. Push the expansion kit into the open ends of the connectors, ensuring the top lips of the expansion kit and connectors match up.

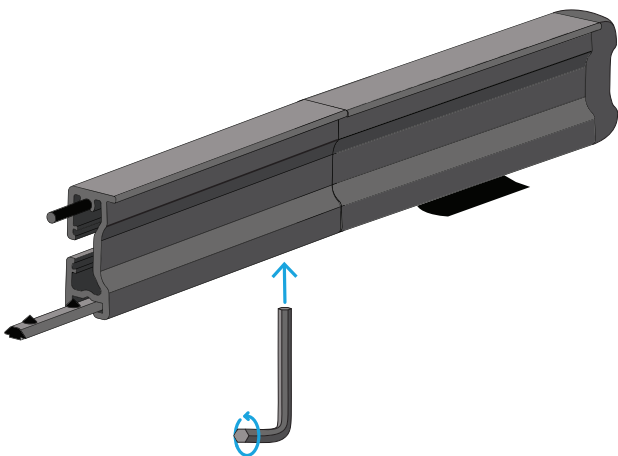

3. Use a hex key to tighten the small screws at the bottom of the expansion.



4. Your Method recycling station is ready to use.

## Assembling a Method Waste Precycler

The Method Precycler can be snapped together quickly with no tools necessary. It can be disassembled quickly for cleaning and is dishwasher safe.

Video instructions available at [methodrecycling.com/nz/resources/how-to-assemble-your-precyclers](https://methodrecycling.com/nz/resources/how-to-assemble-your-precyclers)

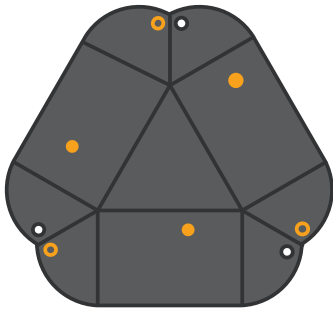

1. Place Precycler on a flat surface (Method logo facing down)

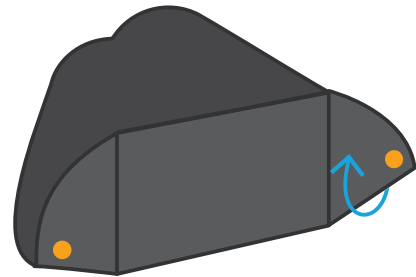

2. Fold up one of the three sides and bend vertical corner folds and then push the button through the hole and fold edges together.

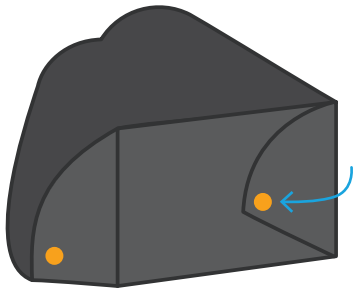

3. Push edges together towards front edge and clip button.

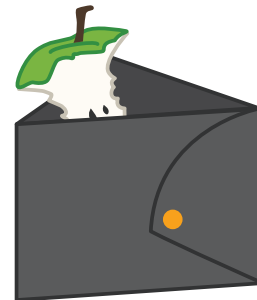

4. Repeat steps 2 and 3 for the remaining two corners. Your Method Waste Precycler is ready to separate waste on your desk.

## Assembling a Method Paper Precycler

Video instructions available at [methodrecycling.com/nz/resources/how-to-assemble-your-precyclers](https://methodrecycling.com/nz/resources/how-to-assemble-your-precyclers)

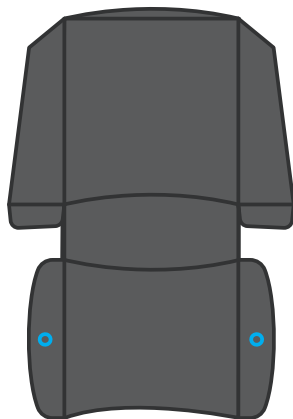

1. Place Precycler on a flat surface (Method logo facing down)

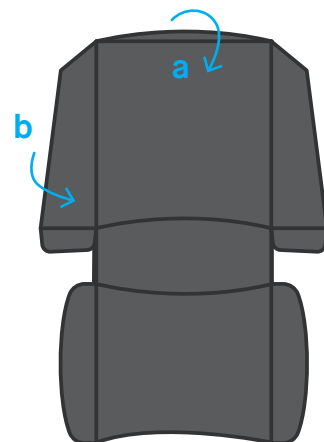

2. Fold longer side upwards at base and then fold one side flap inwards.

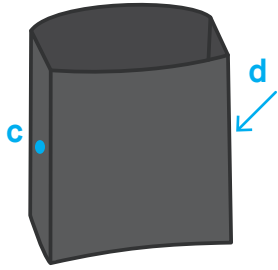

3. Clip buttons on that side together. Repeat this step for the other side.



4. Your Paper Precycler is ready to separate waste on your desk.

## Cleaning and Bin Care

### How to Clean Your Method Bins and Lids

To best clean your bins, we advise a soft cloth and a non-abrasive detergent. We do not recommend putting your Method bins through a dishwasher or rinsing touch lids as this may damage the product. Our open lids have been designed with curves to avoid dirt and grime build-up, and to ensure that the bins are as easy to clean as possible.

### How to Clean Your Precyclers

Method Precyclers can be washed by hand with a soft cloth and a mild detergent, or they can be safely washed in your dishwasher.

### Designed for Indoor Use

Method's recycling bins are designed for an indoor environment, therefore we advise against keeping them outside.

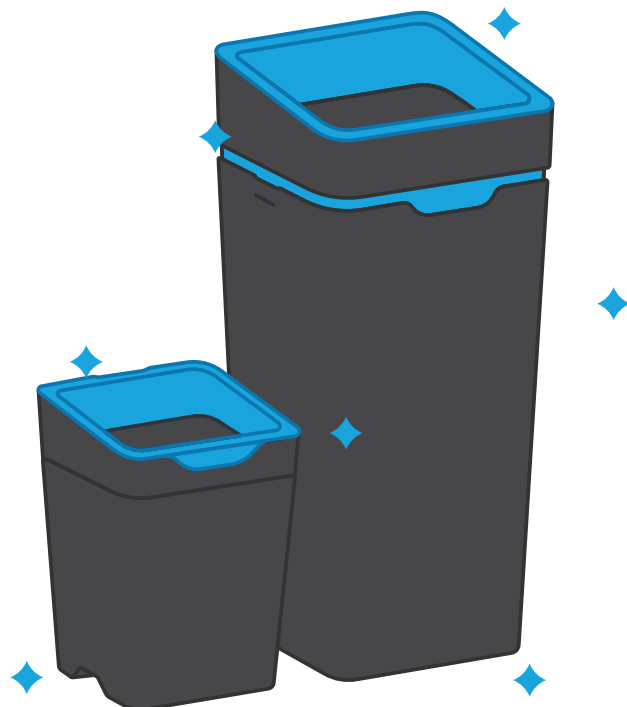

## Applying Vinyl Labels



1. Clean the area thoroughly with diluted IPA - isopropyl alcohol.

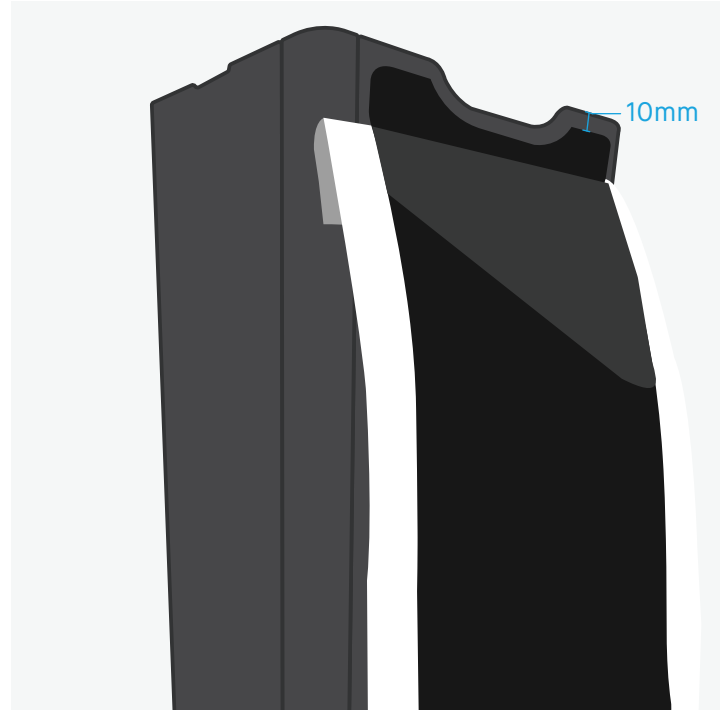

2. Align the sticker with the center of the bin (not with the edges or corners). Allow a 10mm gap between the top of the sticker and the top of the bin.

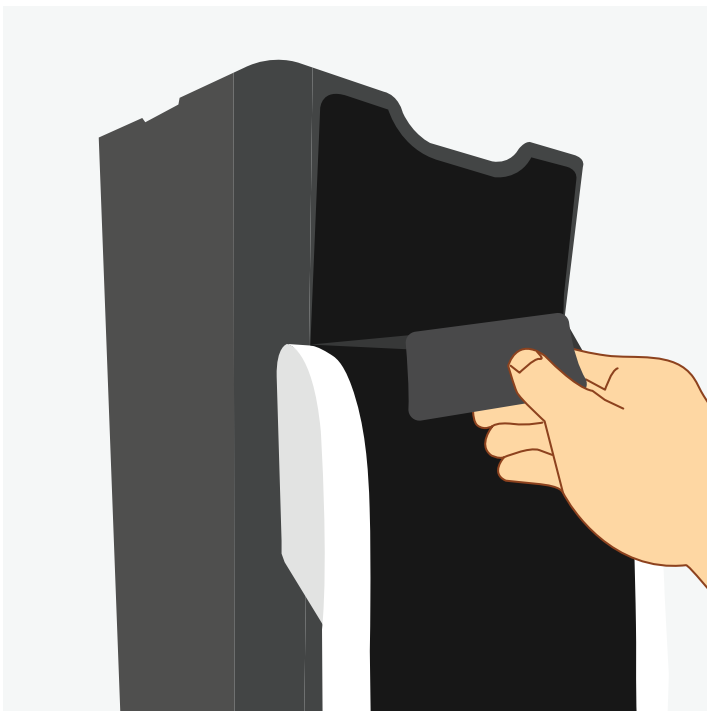

3. Push edges together towards front edge and clip button.



4. Repeat steps 2 and 3 for the remaining two corners. Your Method Waste Precycler is ready to separate waste on your desk.

## Applying Method Stream Labels

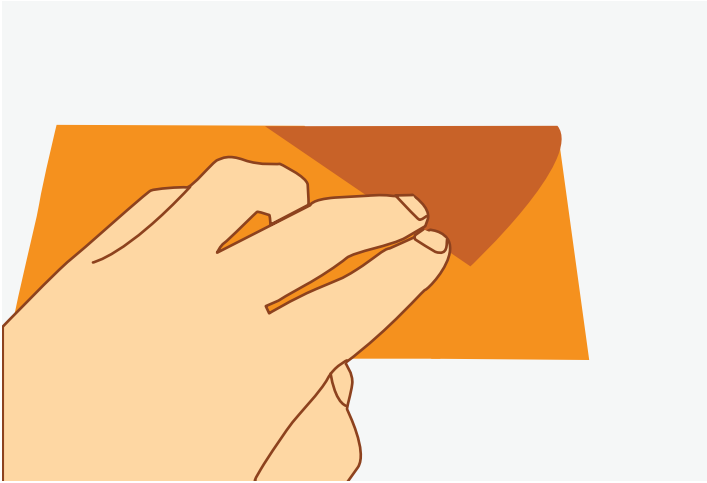

1. Turn the sticker over and peel away slightly from one side.

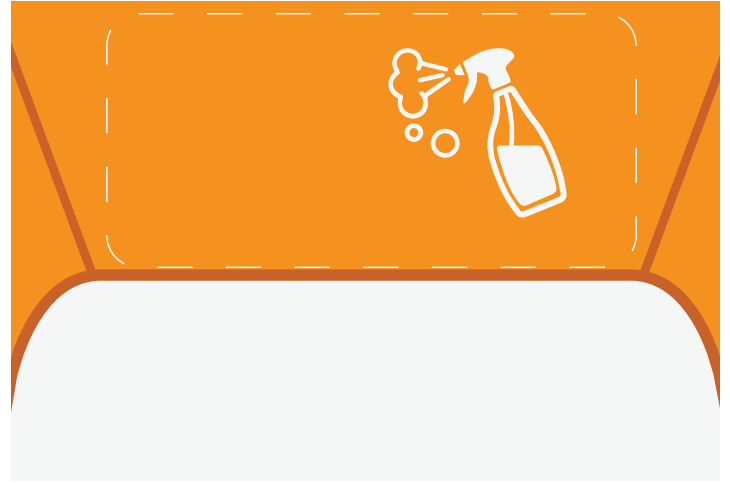

2. Clean the area thoroughly, and then fully dry.

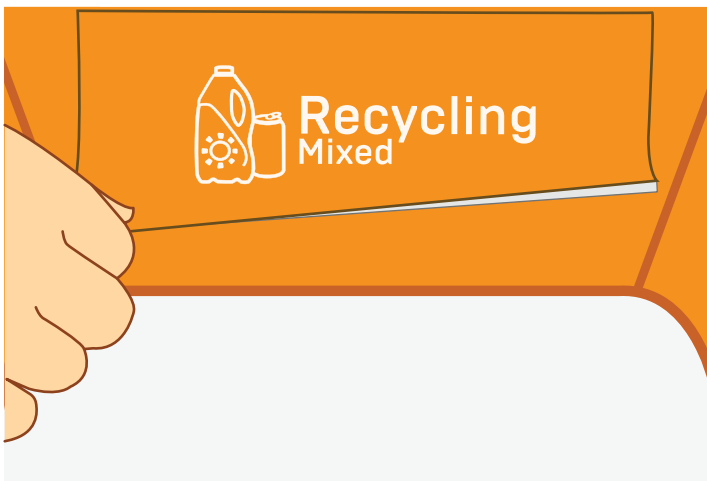

3. Place the sticker on the top of the lid and press it down firmly.

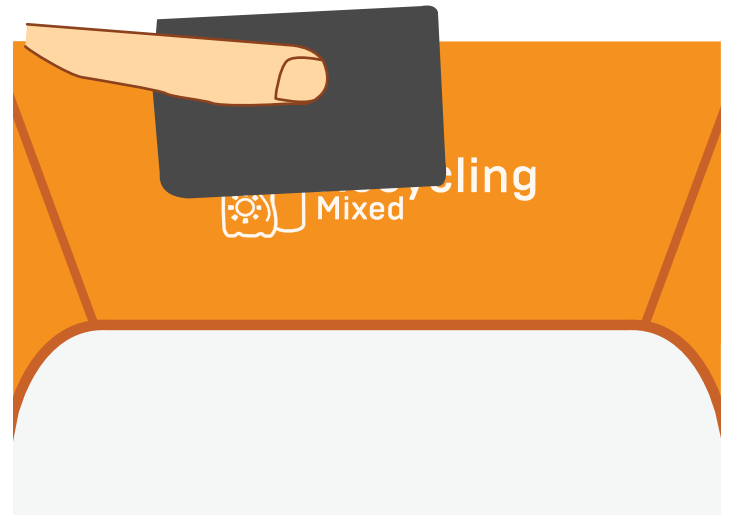

4. Using a thick card, press down on top of the sticker to ensure it is firmly placed.

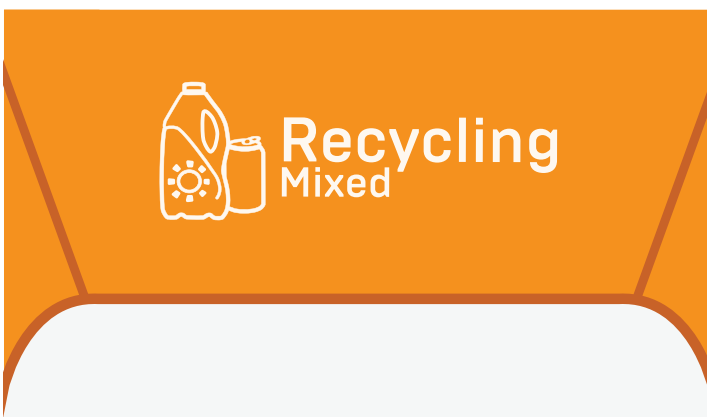

5. Your stream label is applied!