

# Ergoplan Desk

## Assembly Instructions

**Tools Required:** Powered Screwdriver



# Ergoplan Desk

## Assembly Instructions

Page 1

- To prevent possible scratches or damage, assemble the desk upside down on a soft surface such as a blanket, carpet or packaging.

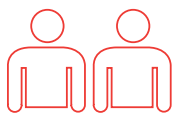

**Recommended  
2-person Step**

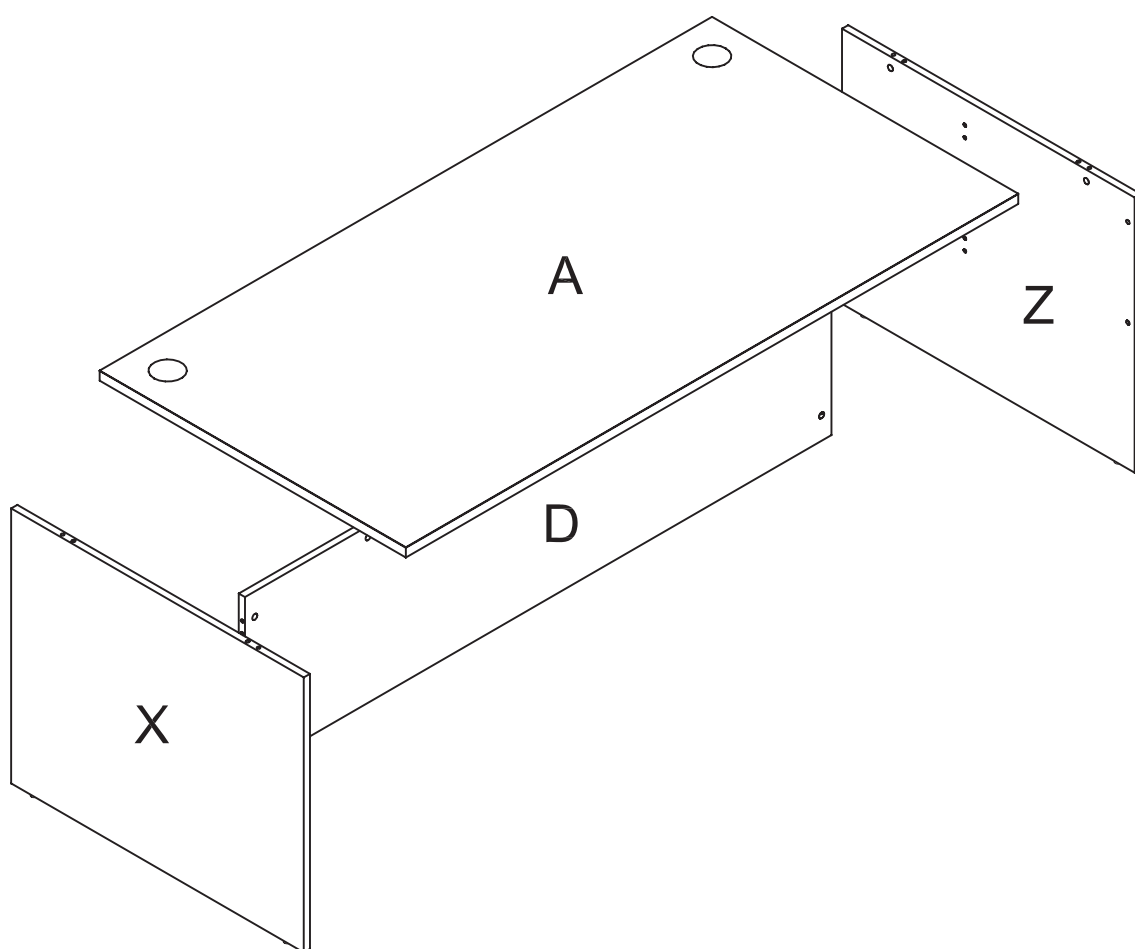

| Item | Description           | Qty | Item      | Description    | Qty |
|------|-----------------------|-----|-----------|----------------|-----|
| A    | Desk Top              | 1   | <b>c1</b> | 6*35 Cam Bolt  | 10  |
| X    | Desk Left Side Panel  | 1   | <b>d1</b> | 8*30 Dowel Pin | 10  |
| Z    | Desk Right Side Panel | 1   | <b>c2</b> | 5/8" Cam Cover | 10  |
| D    | Back Panel            | 1   | <b>b1</b> | Bracket        | 4   |
|      |                       |     | <b>s1</b> | 3.5*15 Screw   | 16  |

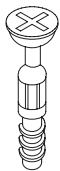

**c1** 10 x 6\*35 Cam Bolts



**d1** 10 x 8\*30 Dowel Pin



**c2** 10 x 5/8" Cam Cover

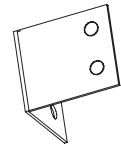

**b1** 4 x Bracket



**s1** 16 x 3.5\*15 Screws

### Pre-installed Parts



**C5** Cam



**o5** Cable Port

### Step 1

Insert cam bolts **(c1)** into panels **A**, **X** and **Z** and insert dowel pins **(d1)** into panels **X**, **Z** and **D** as illustrated below.

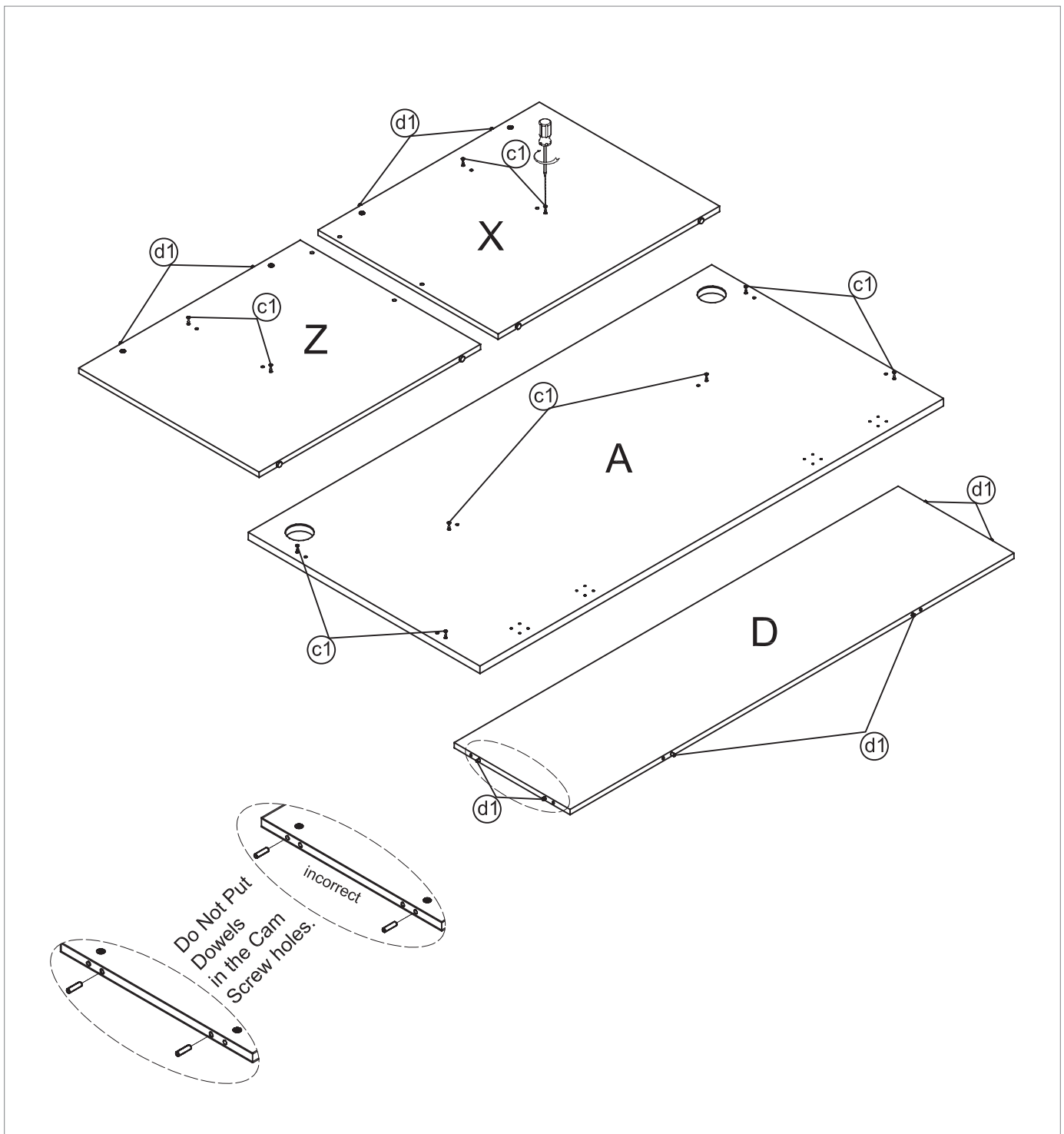

## Step 2

Insert cam bolts **(c1)** on panels **X** and **Z** into cam on panel **D** and tighten in a clockwise direction as illustrated below. Connect panel **D** and panel **X/Z** by bracket **(b1)**.

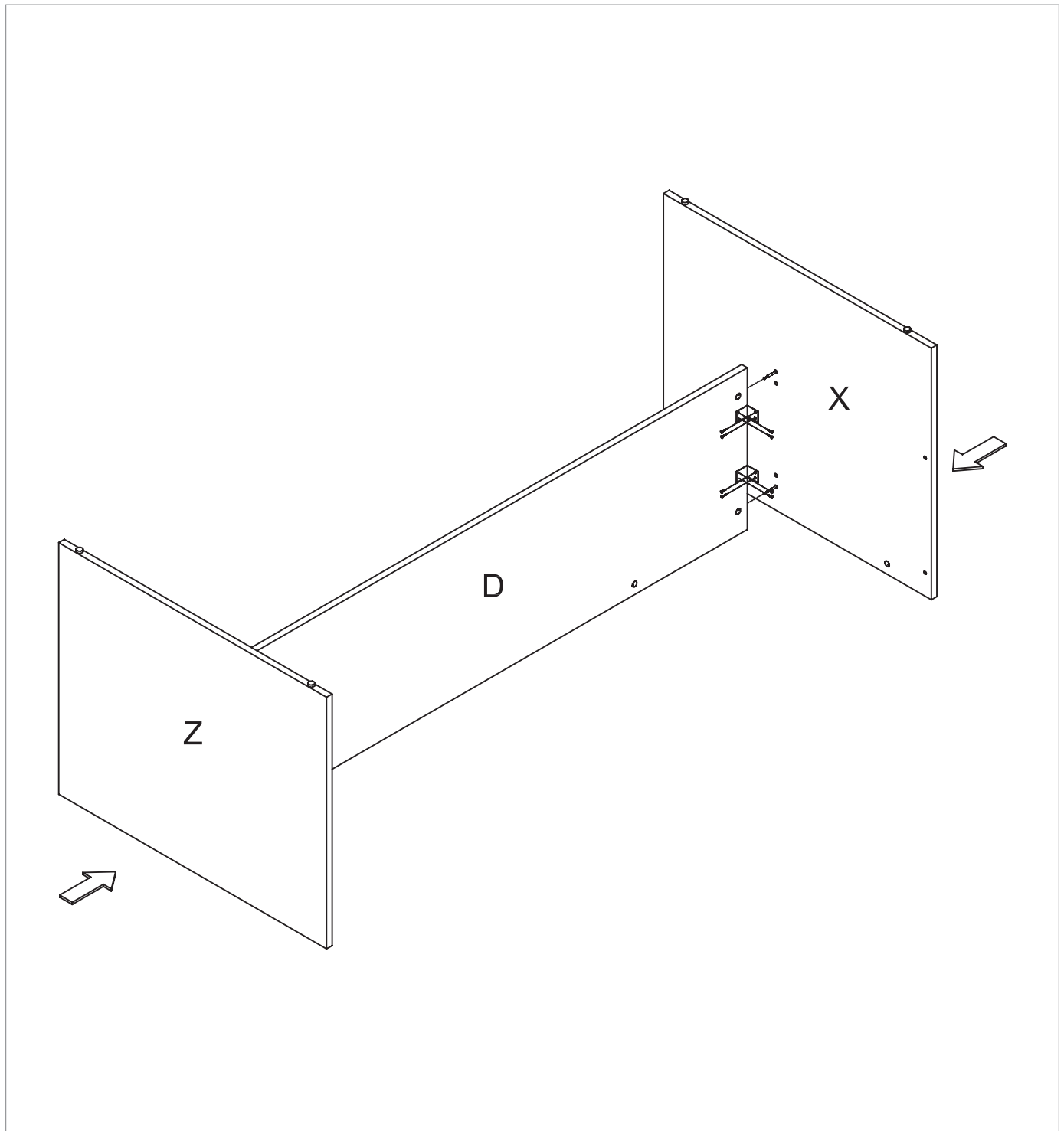

### Step 3

Insert cam bolts **(c1)** on panel **A** into cams on panels **D, X** and **Z** and tighten in a clockwise direction as illustrated above. Cover the cam covers **(c2)** on the top of all the cams.

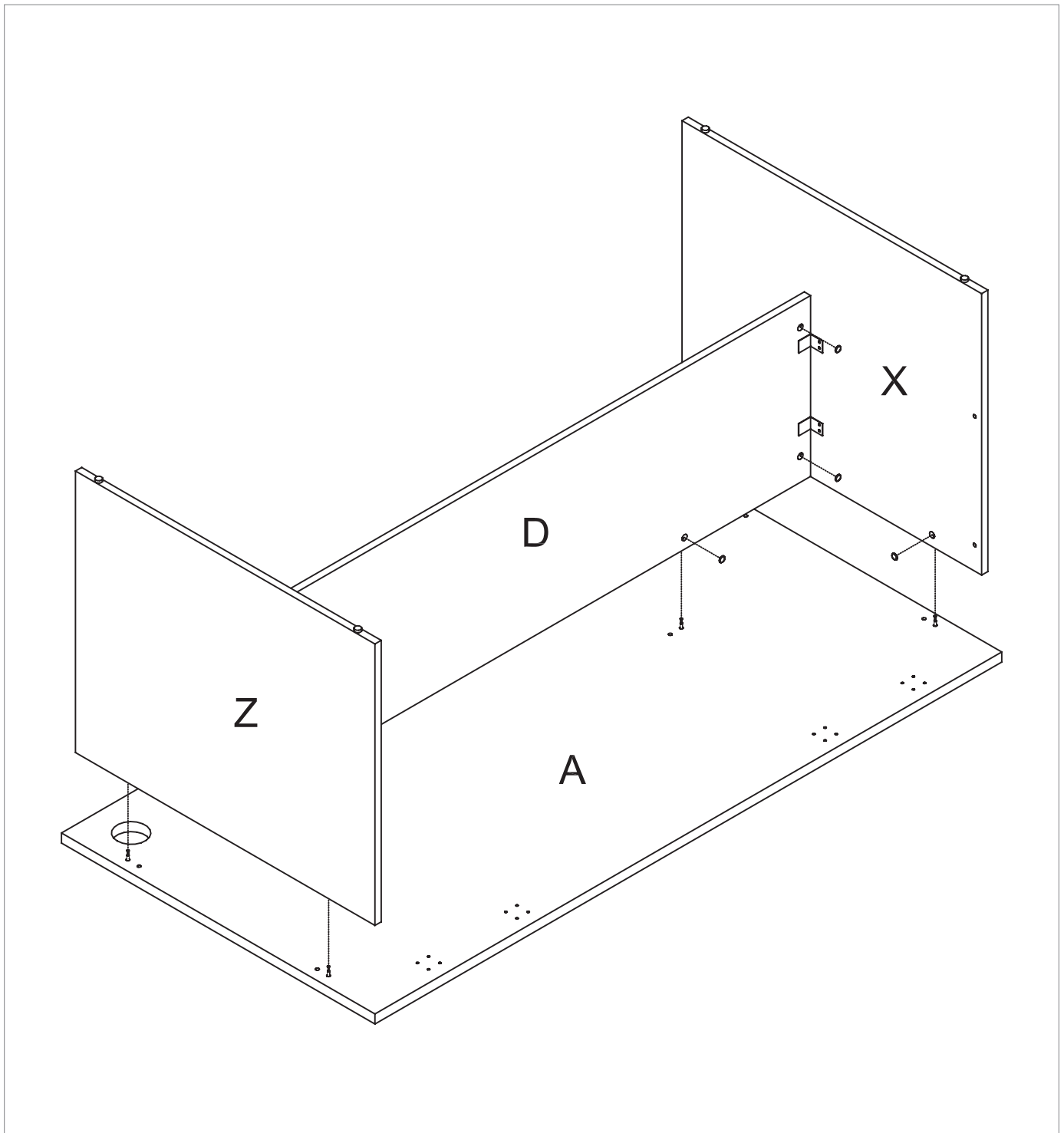

## Complete

---

